

BLDC Motor with Integrated Electronics Type BL36.57



Technical Data

Rated Voltage (V)	No Load Speed (min ⁻¹)	No Load Current (A)	Rated Speed (min ⁻¹)	Rated Current (A)	Rated Torque (Ncm)	Rated Power (W)	Efficiency (%)	Stall Current (A)	Stall Torque (Ncm)
24.0	6050	0.3	5020	1.5	4.79	25	73	7.9	28.4

Ambient Temp.: -10 to +60 °C | Net Weight max. 180 g

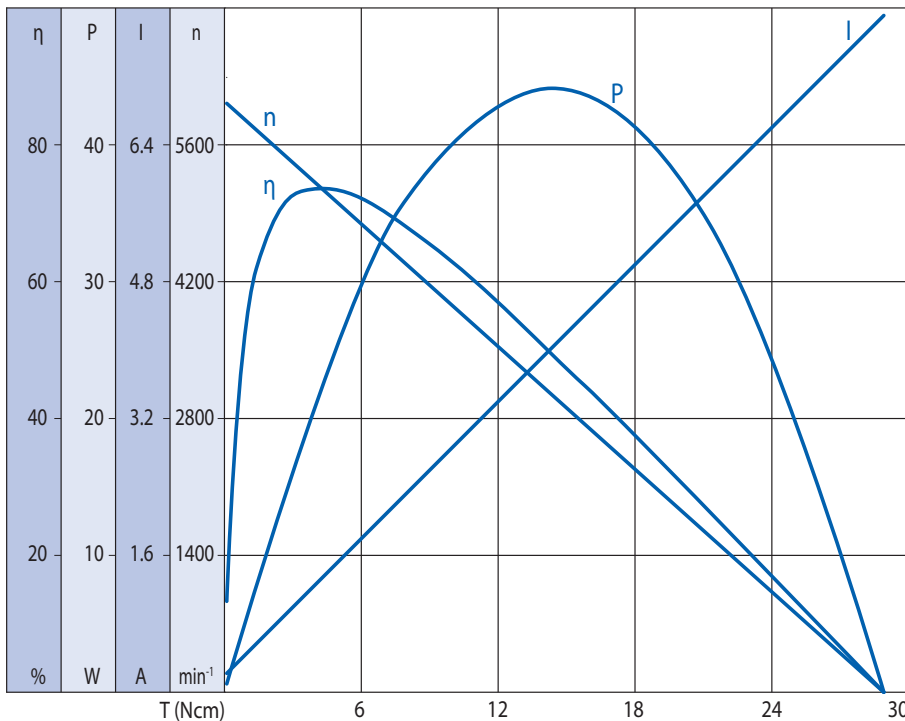
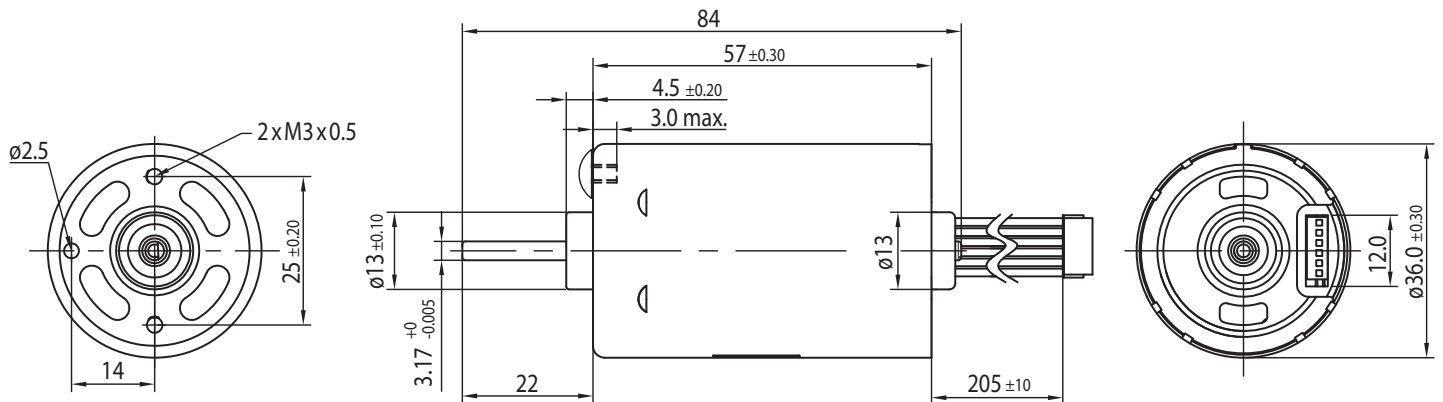

Options

Leads
Connector
Special Shaft
Special Voltage
Encoder

Ball Bearing