

BLDC Motor Planetary Gearbox Type PL32LN-BL42.48



- High Torque
- Low Noise
- Long Life

Gearmotor

Gear Ratio	14	16	18	19	22	25	27	29	35	46
Rated Torque (Ncm)	72	83	96	101	117	131	141	152	184	200
Rated Speed (min ⁻¹)	218	189	163	156	135	120	112	104	86	69
Length L (mm)	47.9									

Gear Ratio	51	59	68	71	79	93	95	107	115	130	139	150	169	181	195	236	308
Rated Torque (Ncm)	249	288	334	349	386	400	400	400	400	400	400	400	400	400	400	400	400
Rated Speed (min ⁻¹)	58.9	51.0	44.1	42.2	38.1	33.5	32.9	29.9	28.2	25.6	24.1	22.6	20.4	19.1	17.9	15.1	11.8
Length L (mm)	57																

Rel. Humidity: 20 to 85% | Ambient Temp.: -10 to +60°C | Net Weight max. 760g

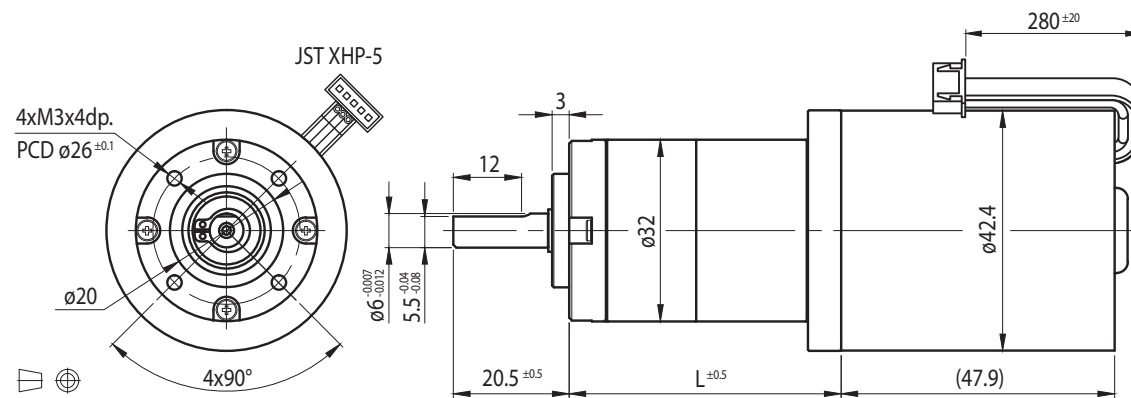

Connections

Harness			AWG
1	Red	U	18
2	Black	V	
3	White	W	
4	Blue	GND	26
5	Yellow	HA	
6	Brown	HB	
7	Gray	HC	
8	Green	VCC	

Motor

Rated Voltage (V)	Rated Torque (Ncm)	Rated Speed (min ⁻¹)	Rated Current (mA)	No Load Speed (min ⁻¹)	No Load Current (mA)	Rated Power (W)
12	7	3000	≤2900	3850	≤500	22
24	7	3000	≤1500	3850	≤300	22

Options

Encoder
Rear Shaft
Connector
Special Shaft
Special Voltage

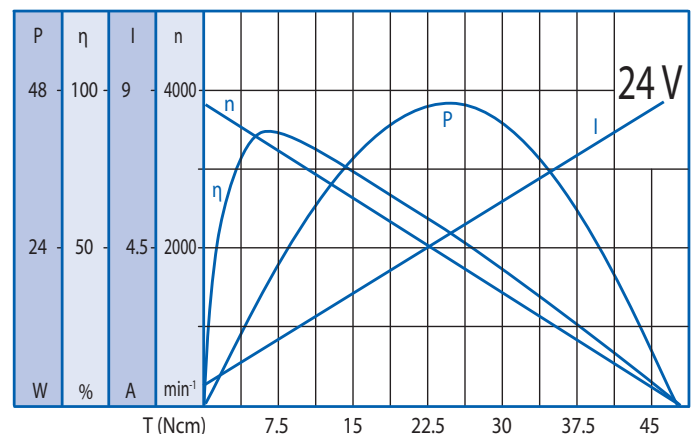
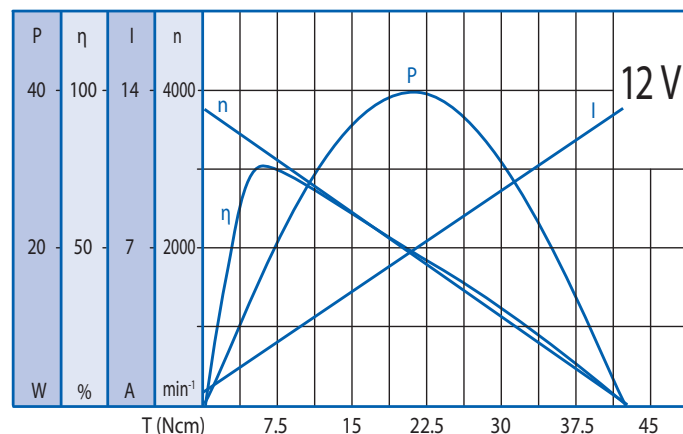

Ball Bearing | Helical Gearing