

# BLDC Motor with Integrated Electronics Planetary Gearbox Type PL42H-BL42



## Gearmotor

Gear Ratio		15	17	20	25	51	64	84	100	120	180	222	294	500	600	720	1062	1470	2500	3000	3600
12V	Rated Torque (Ncm)	16	18.4	22.4	28	48	60	80	96	112	144	176	232	300	300	300	300	300	300	300	300
	Rated Speed (min <sup>-1</sup> )	200	175	150	115	58	47	35	30	25	16	13	10	6.2	5.2	4.5	3.0	2.3	1.3	1.15	0.95
24V	Rated Torque (Ncm)	36	43	50	65	110	140	180	200	200	250	250	300	300	300	300	300	300	300	300	300
	Rated Speed (min <sup>-1</sup> )	300	260	220	170	85	69	52	44	37	25	20	15	8.9	7.5	6.3	4.3	3.1	1.8	1.6	1.3
Length L1 (mm)		39.2	39.2	39.2	39.2	45.9	45.9	45.9	45.9	45.9	52.6	52.6	52.6	52.6	52.6	52.6	59.6	59.6	59.6	59.6	59.6

Above ratings refer to motor model BL42.54

Radial Load (FR): 80 N (10 mm from face mounting) | Axial Load (FA): 30 N | Net Weight max. 586 g

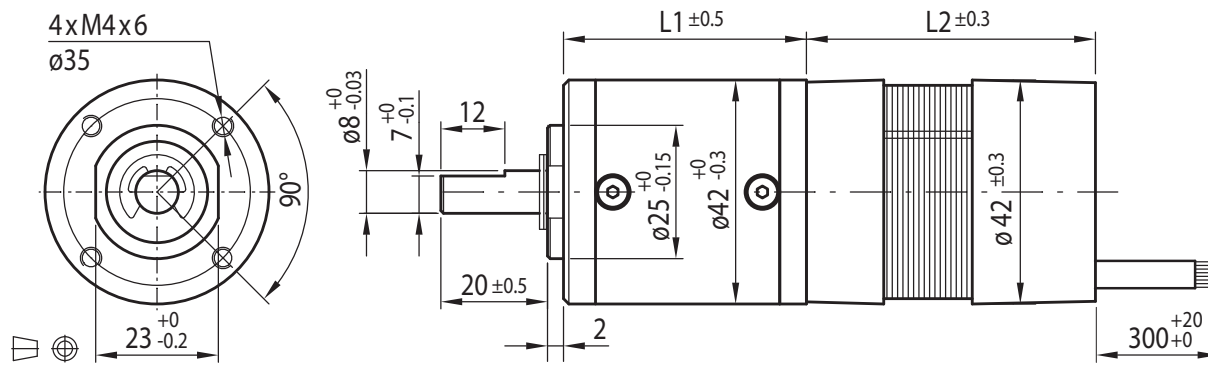

## Motor

Model	BL42.39-12	BL42.39-24	BL42.48-12	BL42.48-24	BL42.54-12	BL42.54-24	BL42.62-12	BL42.62-24
Rated Voltage (V)	12	24	12	24	12	24	12	24
Rated Speed (min <sup>-1</sup> )	4100	7930	3100	5700	3000	4400	3300	6600
Rated Torque (Ncm)	2.6	4	3.4	4.9	1.6	3.7	5.2	7.2
Rated Current (mA)	≤1400	≤1900	≤1350	≤1650	≤800	≤1100	≤2150	≤2700
No Load Current (mA)	≤215	≤640	≤180	≤300	≤160	≤180	≤210	≤450
No Load Speed (min <sup>-1</sup> )	5000	10000	3700	7100	3700	5200	4100	8200
Length L2 (mm)	39	39	48	48	54	54	62	62
No. of Poles	4							
Insulation Class	E							

## Options

Rear Shaft
Connector
Special Shaft
Special Voltage

Ball Bearing  
Helical Gearing

Rel. Humidity: 20 to 85% | Ambient Temp.: -10 to +60 °C

