

# 2-Phase Hybrid Stepper Motor Type SH86 (NEMA 34)



## Technical Data

Model	Rated Current (A)	Resistance ( $\Omega$ )	Inductance (mH)	Lead Wire	Holding Torque (Ncm)	Length L (mm)	Rotor Inertia (gcm <sup>2</sup> )	Weight (kg)	Step Angle (°)
SH86.63-6404	3.0	0.85	7.2	4	250	63	0.64	1.6	1.8
SH86.63-6801	4.0	0.6	2	8	180	63	0.64	1.6	
SH86.92-9403	4.0	0.8	9	4	450	92	1.3	2.6	
SH86.92-9801	4.0	0.89	3.8	8	320	92	1.3	2.6	
SH86.122-1401	5.6	0.55	5.6	4	630	122	1.9	3.8	
SH86.122-1801	4	1.4	5.6	8	450	122	1.9	3.8	

Insulation Resistance: min. 100 M $\Omega$  (at 500VDC)  
Dielectric Strength (1 min): 500 VAC

Operating Temp.: -20 to +50 °C  
Insulation Class: B (130 °C)  
Permissible Temp. Rise: 80 °C

## Options

Step Sizes 0.9 and 3.6°
Encoder
Special Shaft
Rear Shaft Extension
Extension Cable
Connector

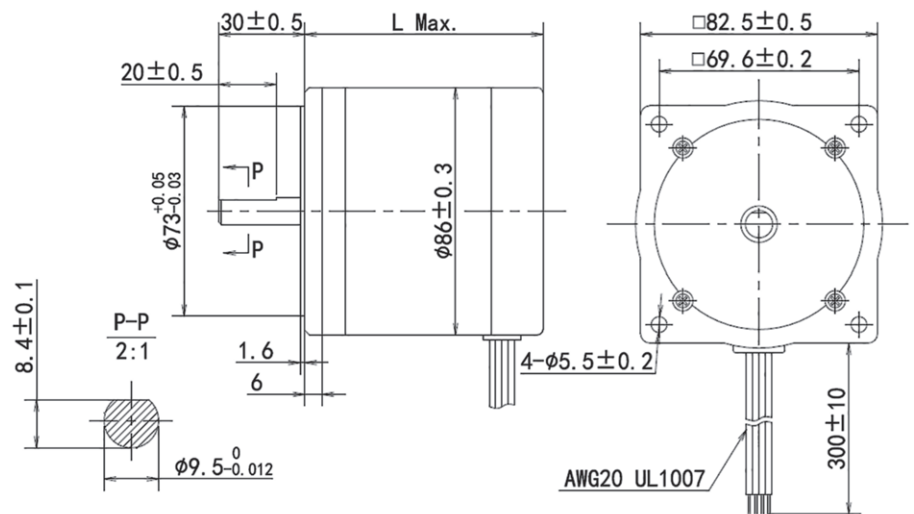

## Connections

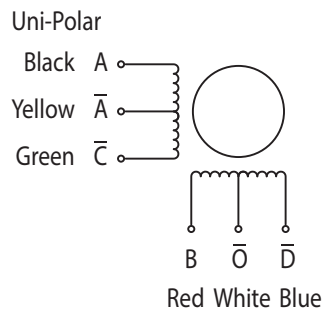
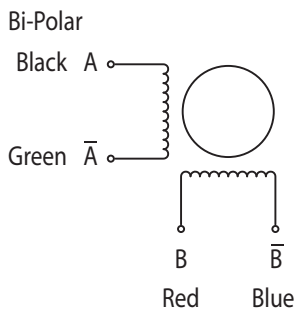

Further winding configurations can be supplied upon request.