

# BLDC Motor with Integrated Electronics Spur Gearbox Type ST37-BL36.41

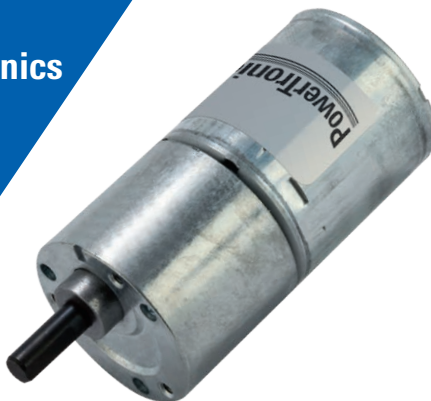

## Gearmotor

Gear Ratio	2	5	10	15	20	30	50	60	80	90	100	120	150	200	240	300	400	500	900	2430
12V	Rated Torque (Ncm)	2.4	6	12	16	22	33	49	59	60	60	60	60	60	60	60	60	60	60	60
	Rated Speed (min <sup>-1</sup> )	2250	900	450	300	225	150	90	75	56	50	45	38	30	23	19	15	11	9	5
24V	Rated Torque (Ncm)	4	10	20	27	36	54	60	60	60	60	60	60	60	60	60	60	60	60	60
	Rated Speed (min <sup>-1</sup> )	1950	780	390	260	195	130	78	65	49	43	39	33	26	20	16	13	10	8	4.3
Length L (mm)	61.7	61.7	61.7	61.7	61.7	61.7	69.7	69.7	69.7	69.7	69.7	69.7	69.7	69.7	74.4	74.4	74.4	74.4	74.4	74.4

Further reduction ratios available

Radial Load (FR): 10 N (10 mm from face mounting) | Axial Load (FA): 10 N | Net Weight max. 265 g

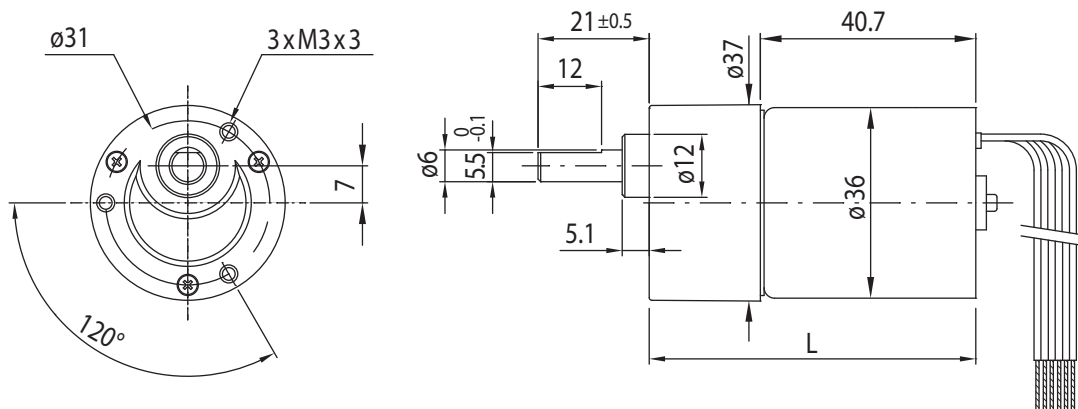

## Motor

Rated Voltage (V)	12	24
Rated Speed (min <sup>-1</sup> )	4500	3900
Rated Torque (Ncm)	1.5	2.5
Rated Current (A)	1.2	0.8
No Load Current (mA)	500	300
No Load Speed (min <sup>-1</sup> )	5300	5000

Rel. Humidity: 20 to 85% | Ambient Temp.: -10 to +60 °C

## Options

Rear Shaft
Connector
Special Shaft
Special Voltage