

DC-Motor Typ DC52.69



Technische Daten

Modell	Nennspannung (V)	Leerlaufdrehzahl (min ⁻¹)	Leerlaufstrom (A)	Nennzahl (min ⁻¹)	Nennstrom (A)	Nennmoment (Ncm)	Nennleistung (W)	Wirkungsgrad (%)	Blockierstrom (A)	Blockiermoment (Ncm)
8010F	12.0	13100	2.3	11100	11.9	8.8	102	72	83	67.7
8012F	12.0	10800	2.0	9000	13.1	11.3	107	68	80	78.7
5524F	24.0	11000	0.95	9700	6.3	11.0	112	74	45	85.8
5025F	12.0	5050	1.2	4000	4.8	8.4	35	63	20	41.8

Umgebungstemp.: -10 bis +60 °C | Nettogewicht max. 480g

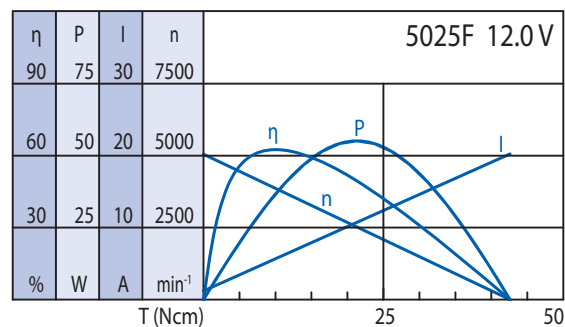
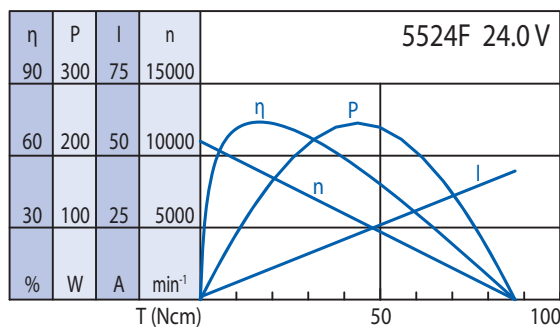
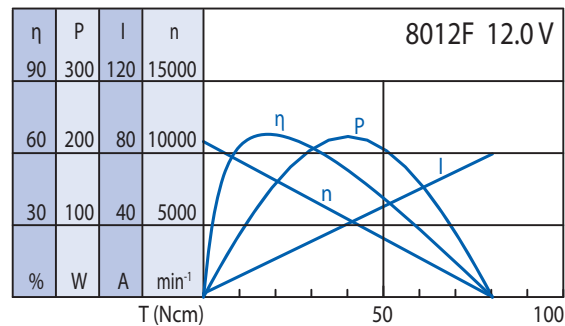
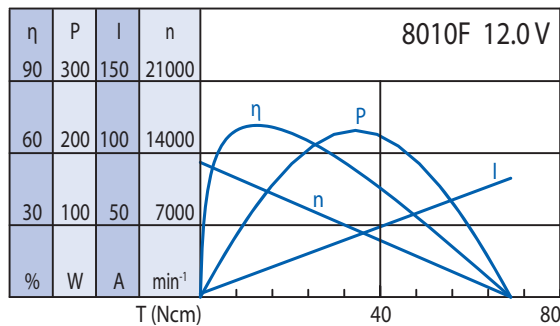
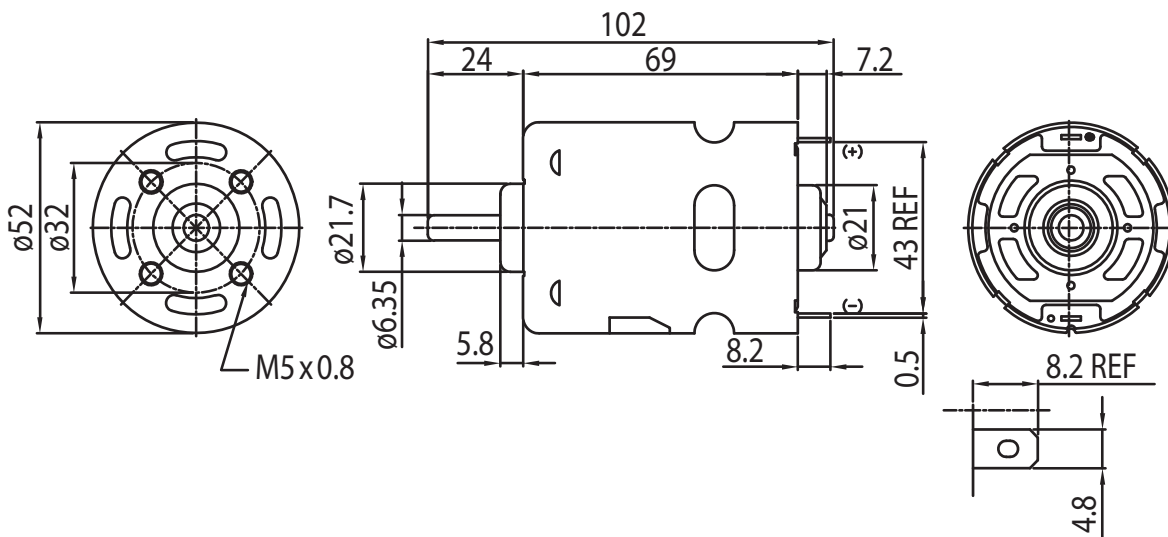

Optionen

Entstörungsfilter
Litzen
Anschlusstecker
Sonderwelle
Sonderspannung
Kugellager
Encoder