

DC Motor Type DC22.31



Technical Data

Model	Rated Voltage (V)	No Load Speed (min ⁻¹)	No Load Current (A)	Rated Speed (min ⁻¹)	Rated Current (A)	Rated Torque (Ncm)	Rated Power (W)	Efficiency (%)	Stall Current (A)	Stall Torque (Ncm)
09540	24.0	6000	0.06	4352	0.15	0.42	1.9	54	0.54	2
11360	24.0	9000	0.08	7174	0.23	0.48	3.6	65	1.19	3
12270	12.0	6000	0.09	4482	0.28	0.41	1.9	60	1.06	2
16180	12.0	9000	0.15	7321	0.47	0.45	3.4	65	2.49	3

Ambient Temp.: -10 to +60°C | Net Weight max. 50g

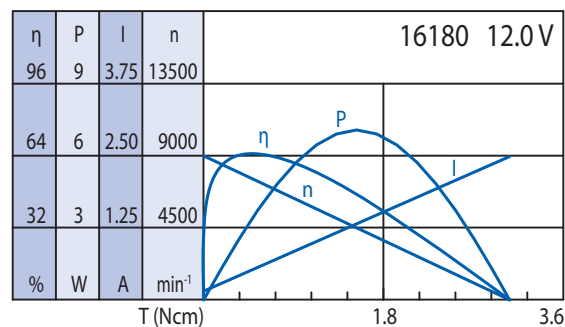
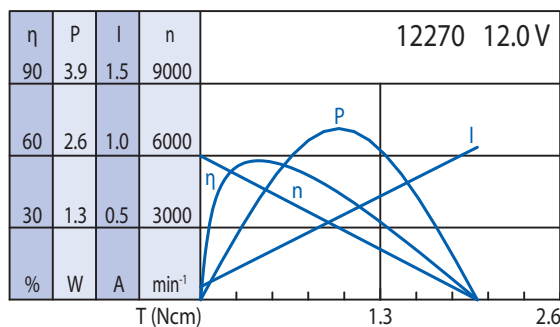
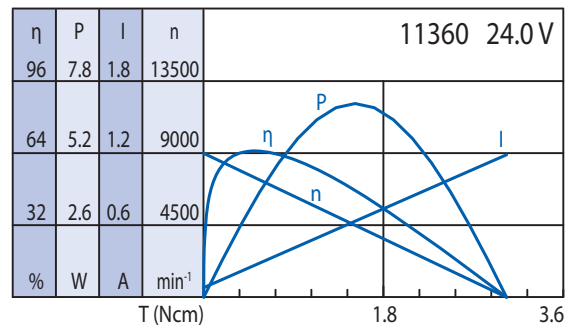
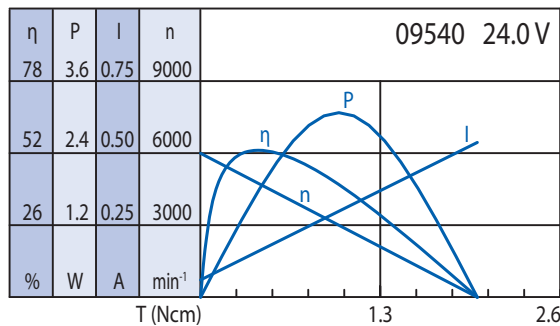
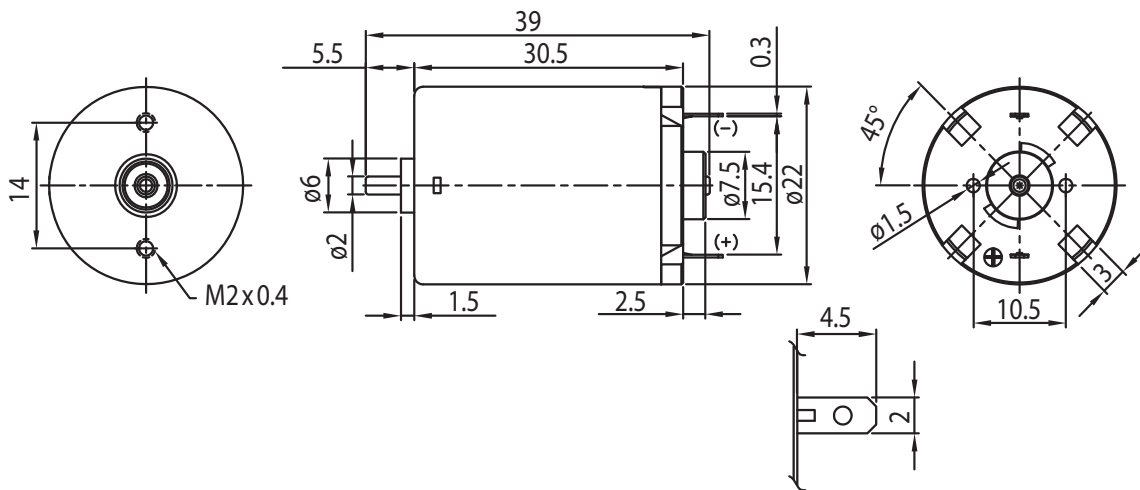

Options

EMC Filter
Leads
Connector
Special Shaft
Special Voltage
Ball Bearing
Encoder