

# DC Motor Planetary Gearbox Type PL16-DC15.27



## Gearmotor

Gear Ratio		4	14	19	29	62	72	84	104	128	157	231	316	370	455	561	690	1014	1621	1996	3027
12V	Rated Torque (Ncm)	0.2	0.6	0.8	1.2	2.2	2.6	3.0	3.8	4.6	5.5	7	9.5	11	13.5	17	21	24	30	30	30
	Rated Speed (min <sup>-1</sup> )	1330	430	315	205	100	85	73	59	48	39	26	19	16	14	11	9	6	4	3	2
24V	Rated Torque (Ncm)	0.3	0.9	1.2	1.8	3.3	3.8	4.5	5.6	6.9	8.5	10	14	16	20	25	30	30	30	30	30
	Rated Speed (min <sup>-1</sup> )	2400	760	555	365	170	150	130	105	85	69	47	34	29	24	20	16	11	7	6	4
Length L (mm)		41.55	45.20	45.20	45.20	48.85	48.85	48.85	48.85	48.85	48.85	52.50	52.50	52.50	52.50	52.50	52.50	56.15	56.15	56.15	56.15

Rel. Humidity: 20 to 85% | Ambient Temp.: -10 to +60°C | Net Weight max. 53g

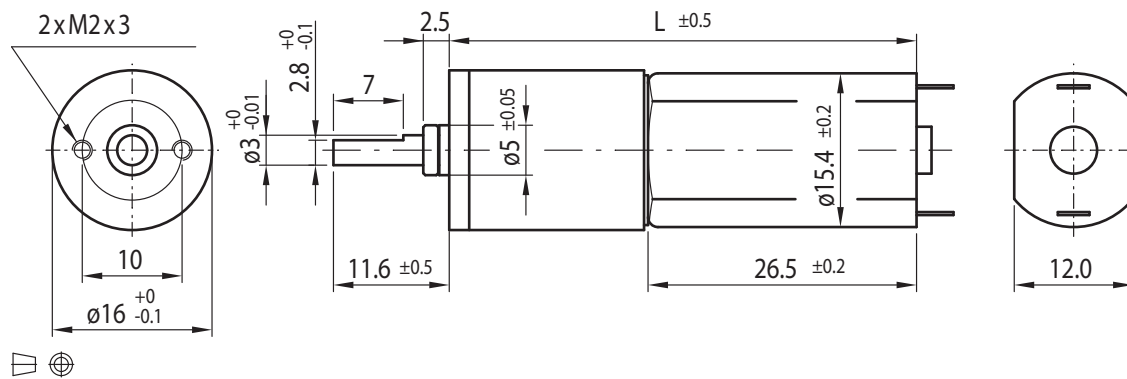

## Options

Encoder
Rear Shaft
EMC Filter
Leads
Connector
Special Shaft
Special Voltage

## Motor

Rated Voltage (V)	Rated Torque (Ncm)	Rated Speed (min <sup>-1</sup> )	Rated Current (mA)	No Load Speed (min <sup>-1</sup> )	No Load Current (mA)	Rated Power (W)
12	0.06	6200	≤ 85	8000	≤ 50	0.394
24	0.09	11000	≤ 90	13500	≤ 50	1.026

Also available as standard: 6V and 9V

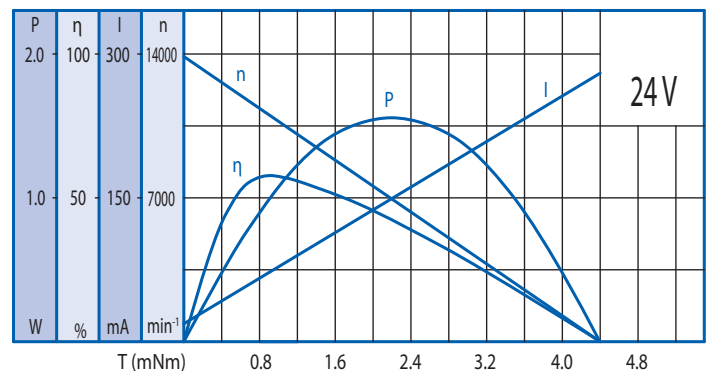
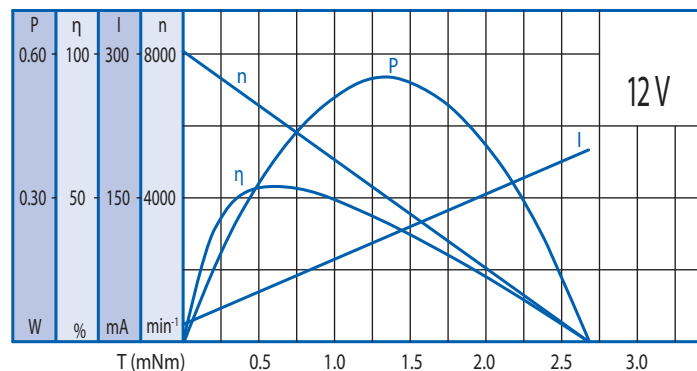

## Gearbox

Gear Ratio	4	14	19	29	62	72	84	104	128	157	231	316	370	455	561	690	1014	1621	1996	3027
Max. Rated Torque (Ncm)	8	12	12	12	16	16	16	16	16	16	20	20	20	20	20	20	24	24	24	24
Max. Peak Torque (Ncm)	24	36	36	36	48	48	48	48	48	48	60	60	60	60	60	60	72	72	72	72

Radial Load (FR): 5N (10mm from face mounting) | Axial Load (FA): 5N