

DC Motor Planetary Gearbox Type PL22C-DC22.38



Gearmotor

Gear Ratio		5	18	20	25	66	77	90	110	136	246	336	393	484	597	735	1079	1475	2124	3968
12V	Rated Torque (Ncm)	2.6	8.5	10	12	27	32	37	40	40	50	50	50	50	50	50	60	60	60	60
	Rated Speed (min ⁻¹)	1500	400	340	280	105	92	79	64	52	29.4	22.4	19.6	16	12.9	10.5	7.4	5.5	4	2
24V	Rated Torque (Ncm)	2.6	8.5	10	12	27	32	37	40	40	50	50	50	50	50	50	60	60	60	60
	Rated Speed (min ⁻¹)	1550	410	350	290	110	95	81	67	56	31	23	20	16.3	13.1	10.7	7.5	5.6	4	2
Length L (mm)		61.5	67.7	67.7	67.7	73.9	73.9	73.9	73.9	73.9	80.1	80.1	80.1	80.1	80.1	80.1	86.3	86.3	86.3	86.3

Radial Load (FR): 12 N (10 mm from face mounting) | Axial Load (FA): 7 N | Net Weight max. 123 g

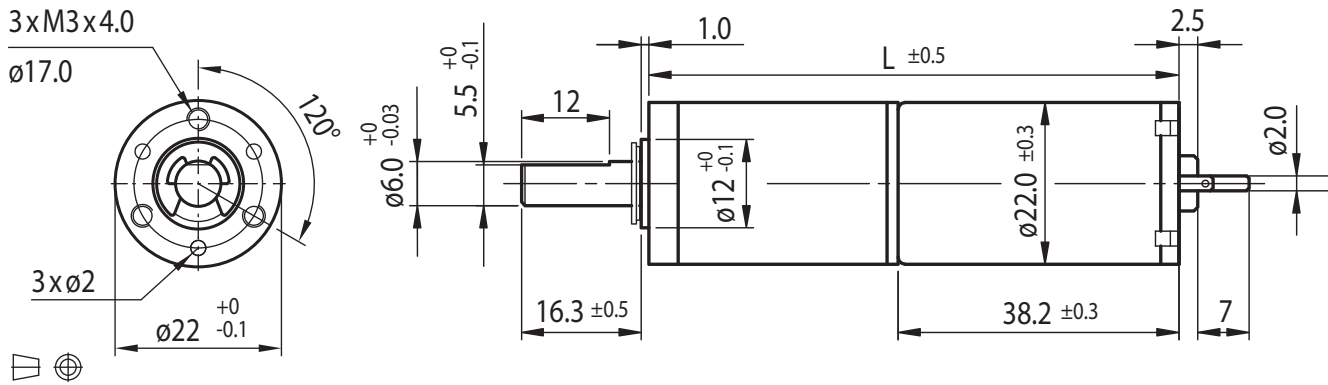

Motor

Rated Voltage (V)	Rated Torque (Ncm)	Rated Speed (min ⁻¹)	Rated Current (mA)	No Load Speed (min ⁻¹)	No Load Current (mA)	Rated Power (W)
12	0.7	7100	≤ 700	9000	≤ 190	5.1
24	0.7	7400	≤ 360	9000	≤ 120	5.3

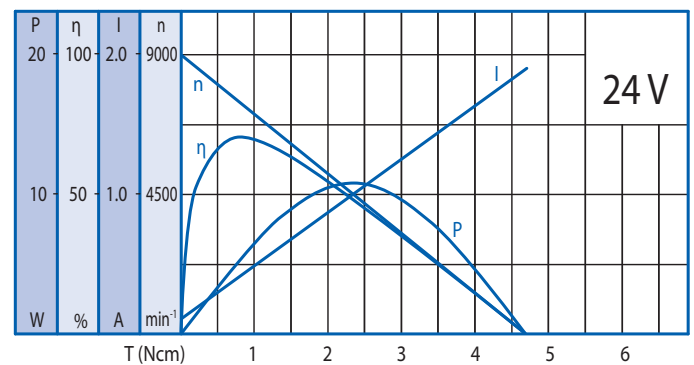
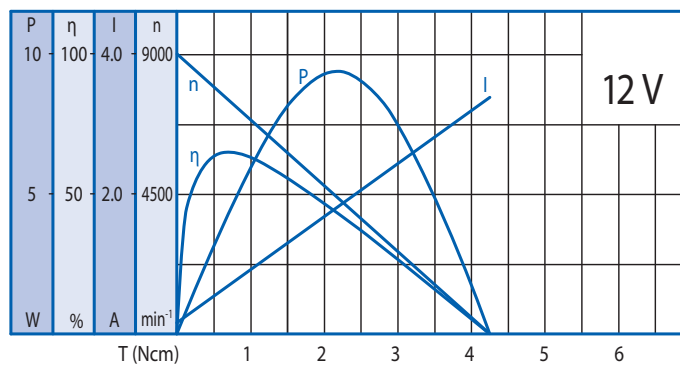

Options

EMC Filter	Special Shaft
Leads	Special Voltage
Connector	Encoder

Gearbox

Gear Ratio	5	18	20	25	66	77	90	110	136	246	336	393	484	597	735	1079	1475	2124	3968
Max. Rated Torque (Ncm)	10	30	30	30	40	40	40	40	40	50	50	50	50	50	50	60	60	60	60
Max. Peak Torque (Ncm)	30	90	90	90	120	120	120	120	120	150	150	150	150	150	150	180	180	180	180

Ball Bearing

Radial Load (FR): 12 N (10 mm from face mounting) | Axial Load (FA): 7 N