

DC Motor Spur Gearbox Type SF70.119-DC36.58

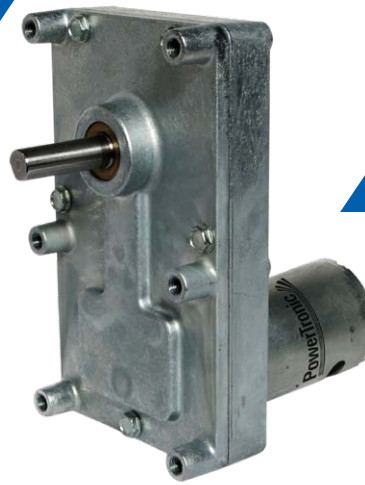

Gearmotor

Gear Ratio	85	126	213	315	470	630	850	1063	1260	1575	2125
Rated Torque (Ncm)	120	176	298	441	658	882	1190	1488	1764	2205	2975
Rated Speed (min ⁻¹)	42	29	17	11.4	7.7	5.7	4.2	3.4	2.9	2.3	1.7

Rel. Humidity: 20 to 85% | Ambient Temp.: -20 to +80 °C | Net Weight max. 1.0 kg

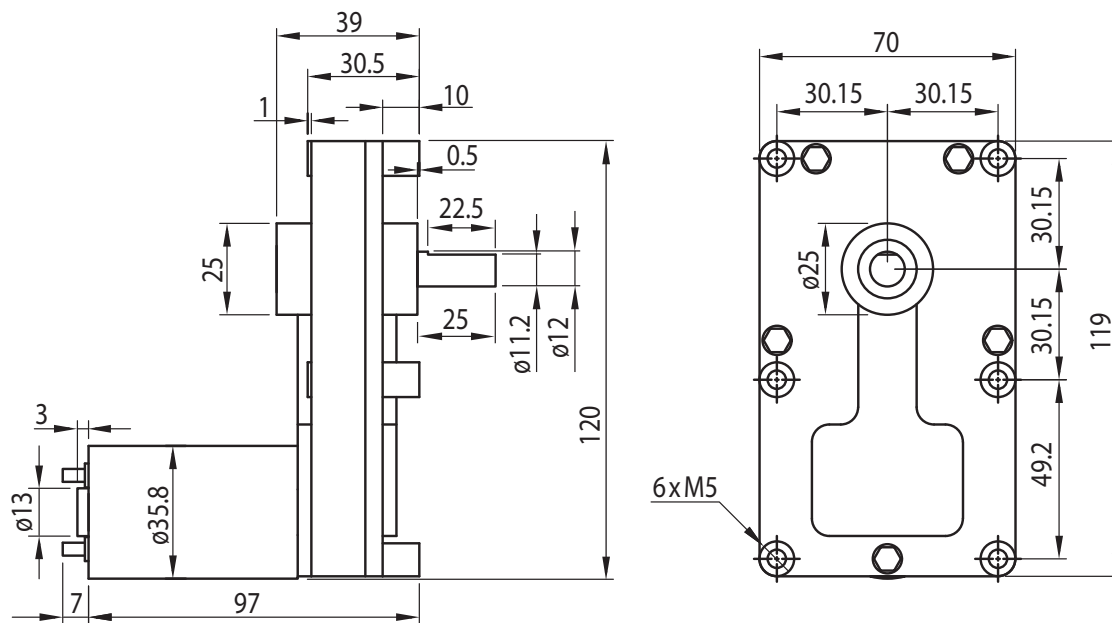

Motor

Rated Voltage (V)	No Load Speed (min ⁻¹)	No Load Current (A)	Rated Speed (min ⁻¹)	Rated Current (A)	Rated Torque (Ncm)	Rated Power (W)
24	4250	0.09	3600	0.44	2.0	7.5

(Also available as standard: 12 V)

Radial Load (FR): 200 N (10 mm from face mounting)
Axial Load (FA): 100 N

Options

Encoder
Rear Shaft
EMC Filter
Leads
Connector
Special Shaft
Special Voltage