

BLDC Motor Planetary Gearbox Type PL42LN-BL42.66



- High Torque
- Low Noise
- Long Life

Gearmotor

Gear Ratio	4	4.6	5.4	7	9	14	16	17	19	23	25	28	34	45	58.2
Rated Torque (Ncm)	41	51	60	73	97	142	164	179	199	241	259	295	356	469	611
Rated Speed (min ⁻¹)	821	654	560	458	348	222	192	176	159	131	122	107	88	67	52
Length L (mm)	56.9							70							

Gear Ratio	50	58	67	70	81	91	98	106	115	128	137	145	166	176	192	232	302
Rated Torque (Ncm)	492	568	657	687	795	895	961	1035	1125	1252	1343	1350	1350	1350	1350	1350	1350
Rated Speed (min ⁻¹)	59.8	51.7	44.7	42.8	37.0	32.8	30.6	28.4	26.1	23.5	21.9	20.9	18.8	18.0	16.8	14.3	11.3
Length L (mm)	83.2																

Rel. Humidity: 20 to 85% | Ambient Temp.: -10 to +60°C | Net Weight max. 1440g

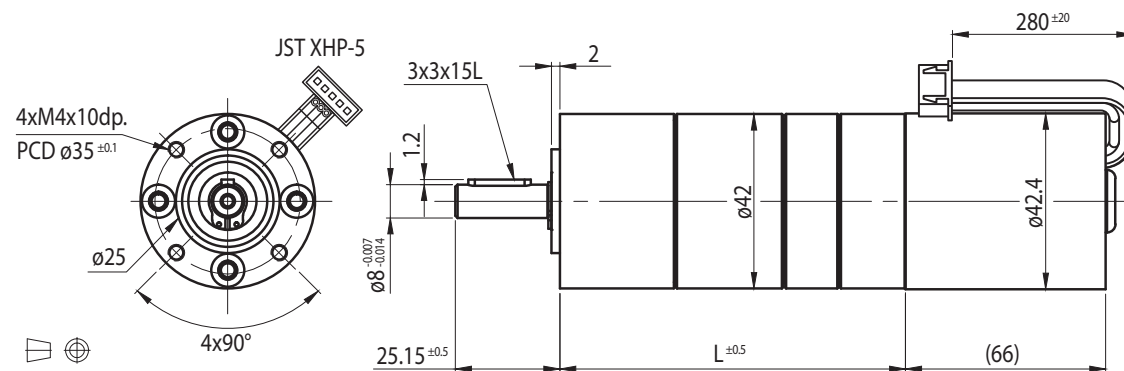

Connections

Harness			AWG
1	Red	U	18
2	Black	V	
3	White	W	
4	Blue	GND	26
5	Yellow	HA	
6	Brown	HB	
7	Gray	HC	
8	Green	VCC	

Motor

Rated Voltage (V)	Rated Torque (Ncm)	Rated Speed (min ⁻¹)	Rated Current (A)	No Load Speed (min ⁻¹)	No Load Current (A)	Rated Power (W)
12	14	3000	≤5.4	3750	≤0.7	44
24	14	3000	≤2.8	3750	≤0.4	44

Options

Encoder
Rear Shaft
Connector
Special Shaft
Special Voltage

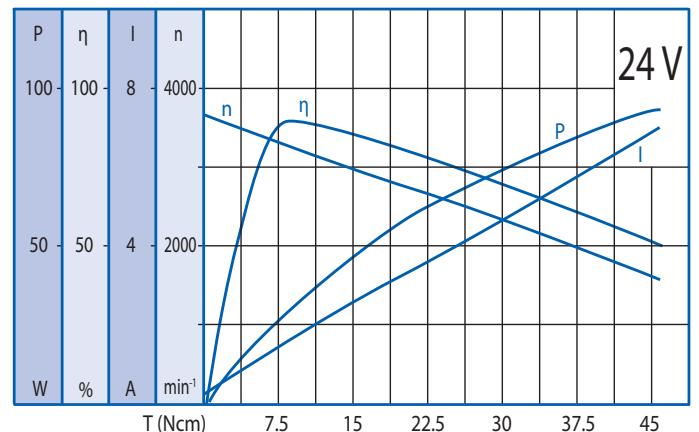
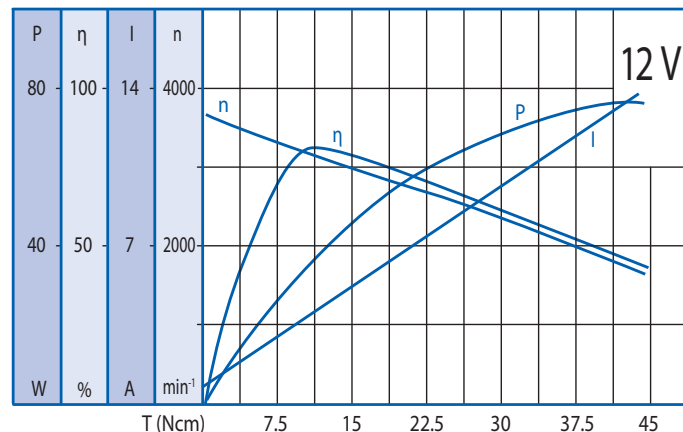

Ball Bearing | Helical Gearing