

DC-Motor Typ DC16.27



Technische Daten

Modell	Nennspannung (V)	Leerlaufdrehzahl (min ⁻¹)	Leerlaufstrom (A)	Nennzahl (min ⁻¹)	Nennstrom (A)	Nennmoment (Ncm)	Nennleistung (W)	Wirkungsgrad (%)	Blockierstrom (A)	Blockiermoment (Ncm)
13130	2.0	3700	0.038	3000	0.11	0.03	0.1	42	0.45	0.17
11170	7.0	10300	0.046	8500	0.17	0.07	0.6	51	0.80	0.46
09250	8.0	7900	0.027	6300	0.11	0.07	0.5	51	0.42	0.35
06340	12.0	8000	0.028	5544	0.08	0.07	0.4	42	0.42	0.26

Umgebungstemp.: -10 bis +60 °C | Nettogewicht max. 18g

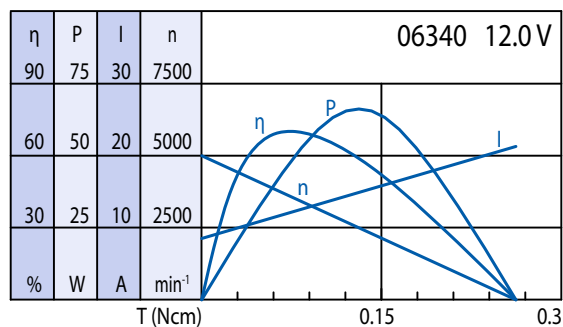
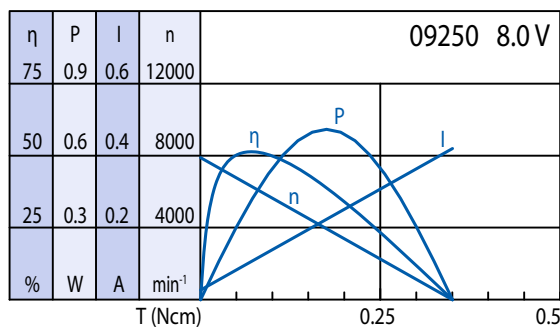
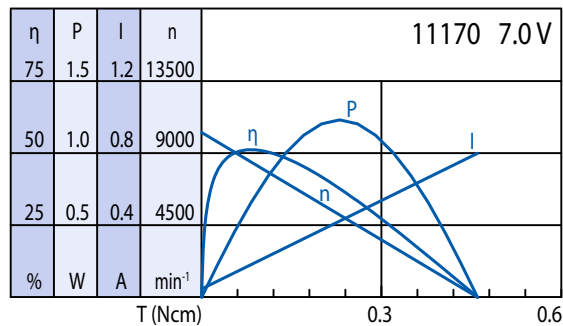
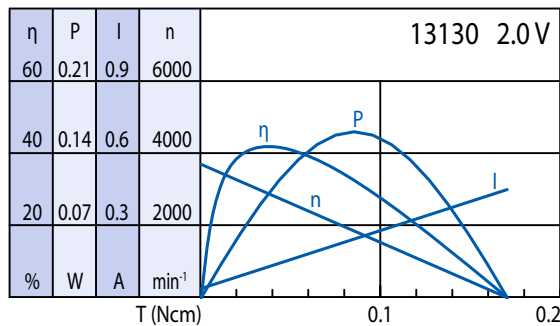
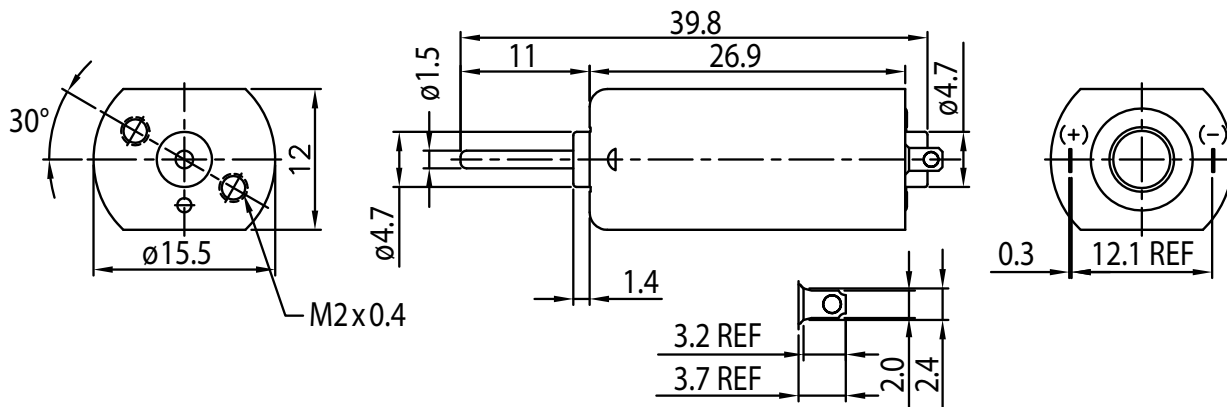

Optionen

Entstörungsfilter
Litzen
Anschlussstecker
Sonderwelle
Sonderspannung
Kugellager
Encoder